

4 3 2 1

REVISIONS					
ZONE	LETTER	DESCRIPTION	DATE	CHECKED	APPROVED

SHOWN AT MID-STROKE

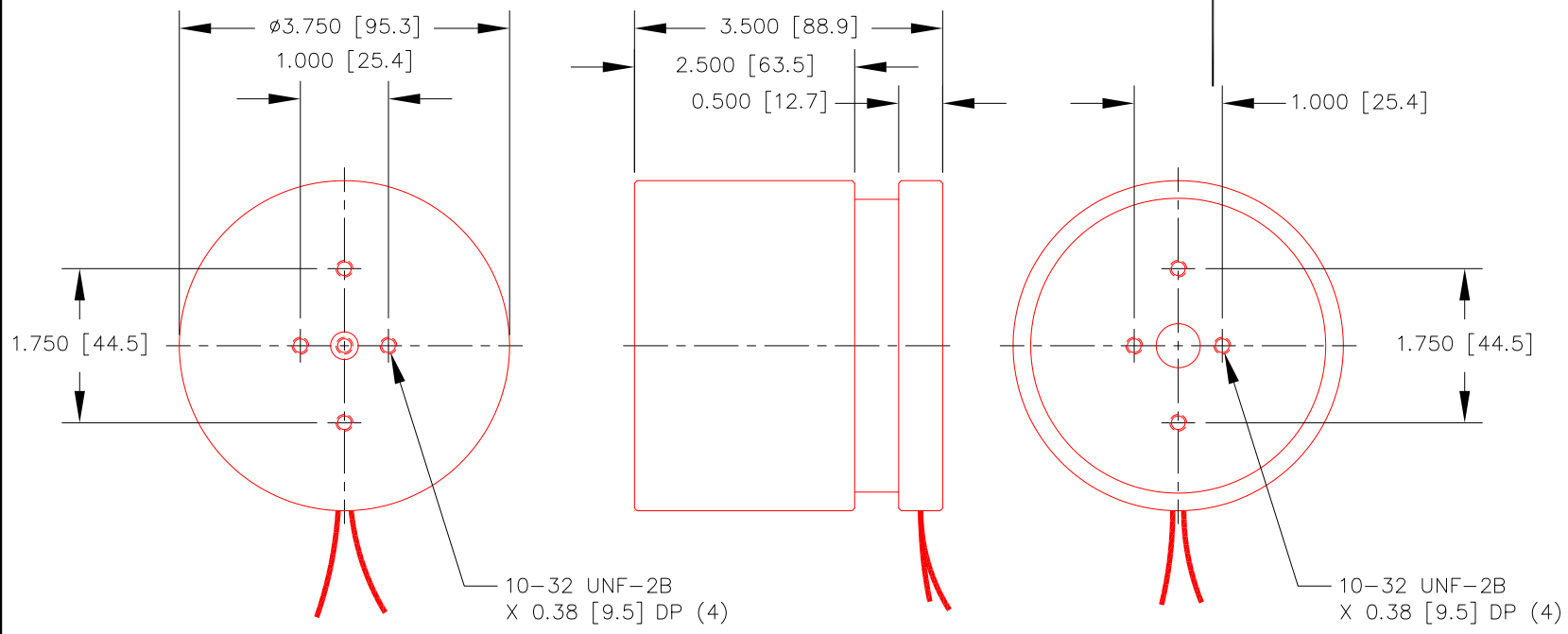

INTERMITTENT FORCE @10% DUTY CYCLE	342.0 N	77.1 LB
CONTINUOUS FORCE	108.2 N	24.4 LB
FORCE CONSTANT	21.1 N/A	4.8 LB/A
BACK EMF CONSTANT	21.1 V/M/S	0.54 V/IN/S
STROKE	38.1 mm	1.50 IN
COIL CLEARANCE PER SIDE	0.64 mm	0.025 IN
COIL ASSY MASS	484 GR	1.07 LB
BODY MASS	3.00 KG	6.61 LB
COIL RESISTANCE	2.1 Ohms	
COIL INDUCTANCE @ 1000 Hz	1.2 mH	
MAX CONTINUOUS POWER	55 W	

ALL VALUES AT 25°C

NOTES :
UNLESS OTHERWISE SPECIFIED

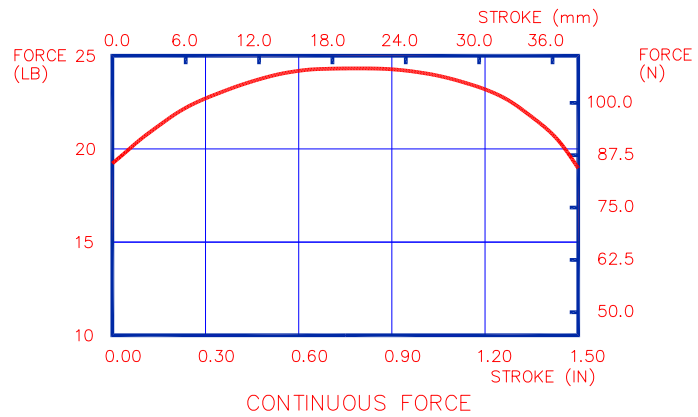

THIS DOCUMENT, WHETHER OR NOT MARKED AS PROPRIETARY, IS CONSIDERED CONFIDENTIAL AND SHALL REMAIN THE PROPERTY OF MOTICONT AND SHALL BE RETURNED TO MOTICONT UPON REQUEST WITH ALL COPIES MADE THEREOF. THIS DOCUMENT CANNOT BE UTILIZED IN THE MANUFACTURE OF ARTICLES SOLD OR OFFERED OR DISCLOSED TO ANYONE AND NO USE OF IT CAN BE MADE UNLESS EXPRESSLY AUTHORIZED BY AND UNDER THE DIRECTION OF MOTICONT. POSSESSION OF THIS DOCUMENT IS ACCEPTED SUBJECT TO THE FOREGOING.

DIMENSIONS ARE IN INCHES (mm) TOLERANCES ON: DECIMALS FRACTIONS ANGLES .XXX .XX ± 1/125 ± 1/2" ± .005 ± .01 UNLESS OTHERWISE SPECIFIED		MATERIAL	CONTRACT		motiCont LINEAR VOICE COIL MOTOR			
FINISH		DRN						
USED ON		CHKD			SIZE	CODE	DWG. NO.	REV.
NEXT ASSY		APPVD			A		LVCM-095-064-01	1
APPLICATION		APPVD			SCALE: 1 / 2		SHEET 1 OF 1	

B
C
D
A